

大学院医学系研究科教育研究支援センター

# 共同利用機器部門

**Laboratory for Analytical Instruments**

Education and Research Support Center

Gunma University Graduate School of Medicine

# 1<sup>st</sup> Floor of Clinical Research Center Building

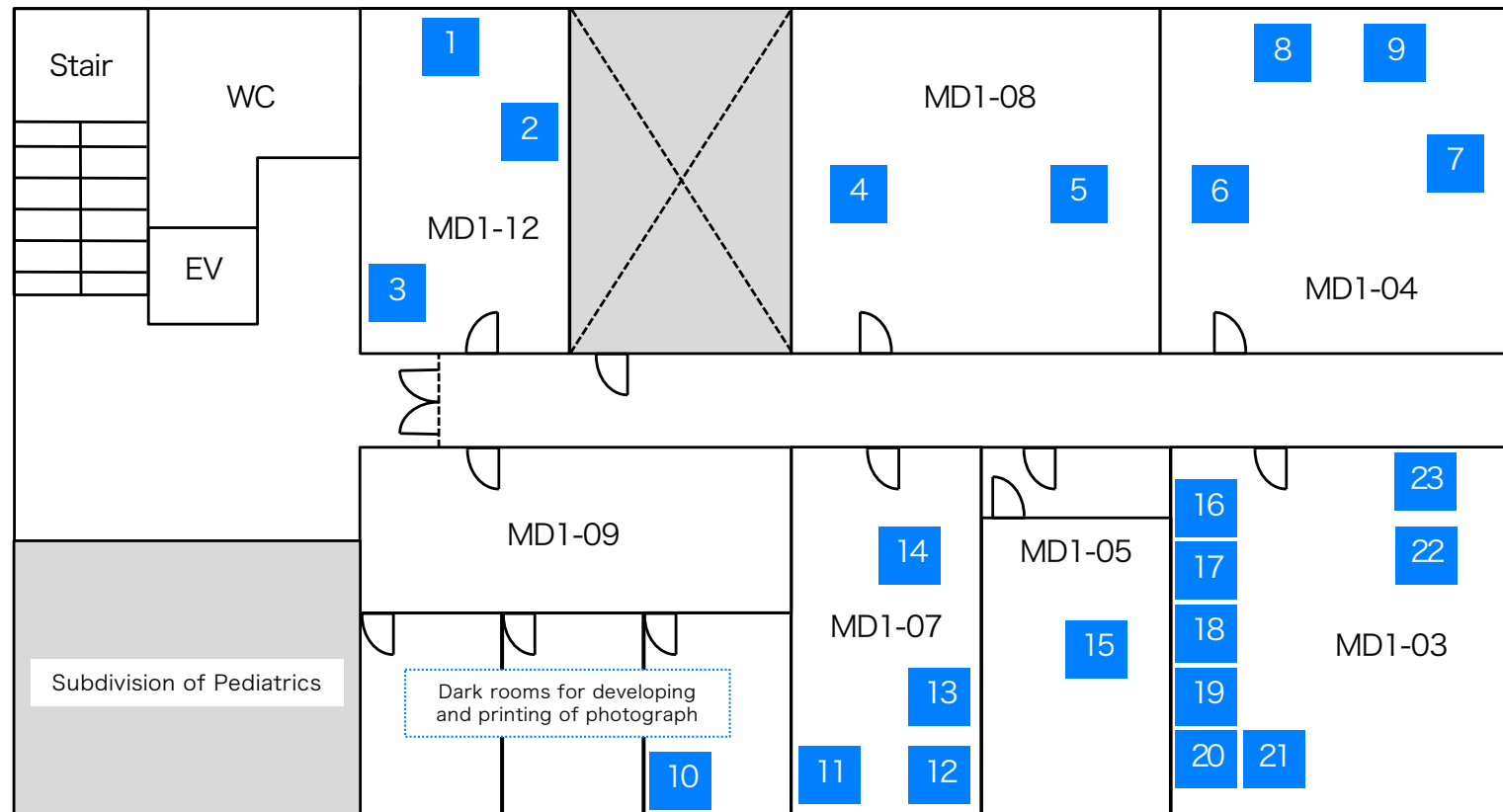

- |                                                               |                                                       |                                            |
|---------------------------------------------------------------|-------------------------------------------------------|--------------------------------------------|
| (1) Freeze-fracture System (BAF-060)                          | (10) Enlarger (A690)                                  | (16) Critical point dryer (HCP-2)          |
| (2) Automatic ice maker                                       | (11) Microtome (Ultracut Omu4)                        | (17) Freeze dryer (VFD-21S)                |
| (3) High Pressure Freezer (HPM-100)                           | (12) Microtome (Ultracut S)                           | (18) Sputter coater (E-1020)               |
| (4) Transmission electron microscope (JEM-1010)               | (13) Microtome (Ultracut Nova)                        | (19) Osmium coater (Neoc-ST)               |
| (5) Transmission electron microscope (JEM-200CX)              | (14) Knife maker for microtome (7800)                 | (20) Ion coater (IB-5)                     |
| (6) Stochastic optical reconstruction microscope (N-STORM-C2) | (15) Multiphoton excitation microscope (FV1200MPE-RS) | (21) High vacuum evaporator (HUS-5GB)      |
| (7) Third-generation sequencer (PacBio RS II)                 |                                                       | (22) Scanning electron microscope (S-4100) |
| (8) In vivo imaging system (Lumina III)                       |                                                       | (23) Incubator                             |
| (9) Microwave applicator (MMW-05)                             |                                                       |                                            |

# 2<sup>nd</sup> Floor of Clinical Research Center Building

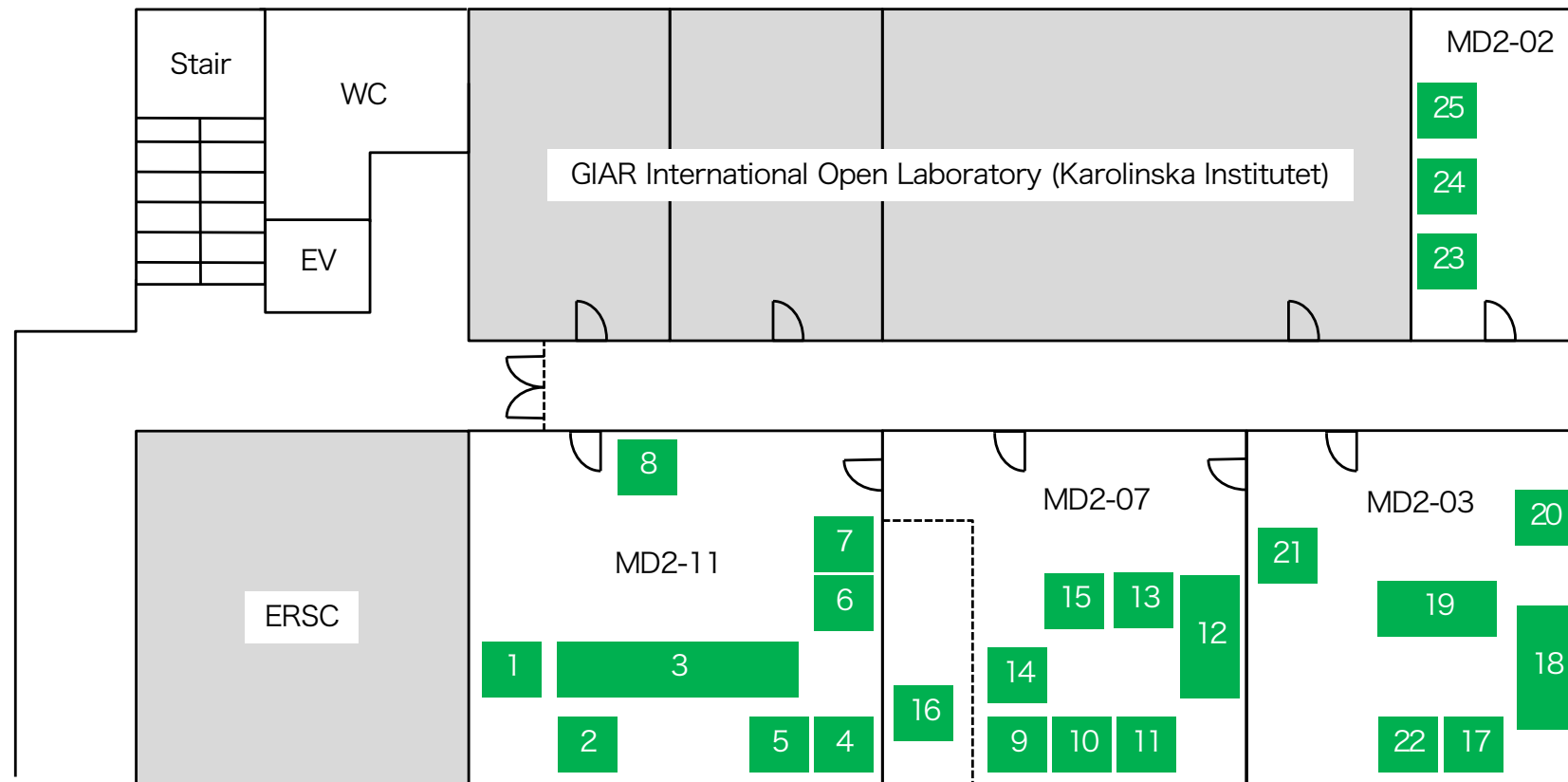

- |                                                      |                                                            |                                                             |
|------------------------------------------------------|------------------------------------------------------------|-------------------------------------------------------------|
| (1) Variable mode laser scanner (FLA-9500)           | (9) Microplate reader (xMark)                              | (17) Cryomicrotome (CM3050S)                                |
| (2) Centrifugal evaporator (miVac Duo LV)            | (10) Microplate reader (EnSpire)                           | (18) Imaging cytometer (IN Cell Analyser)                   |
| (3) Real-time PCR (Eco)                              | (11) UV-visible spectrophotometer (BioSpec-Nano)           | (19) Mass spectrometer (ultrafleXtreme)                     |
| (4) Ultracentrifuge (XL-90)                          | (12) Microarray scanner (Agilent)                          | (20) Real-time PCR (StepOne Plus)                           |
| (5) Automated DNA size selection system (BluePippin) | (13) DNA shearing system (Covaris M220)                    | (21) Matrix Deposition Device for MALDI Imaging (ImagePrep) |
| (6) Ultracentrifuge (CS-100GXII)                     | (14) On-chip electrophoresis system (Agilent 2100)         | (22) Automated nucleic acid purification system (QIACube)   |
| (7) Ultracentrifuge (CP-80MX)                        | (15) Digital PCR (QX200)                                   | (23) Flowcytometer (Attune)                                 |
| (8) Variable mode laser scanner (Typhoon 9210)       | (16) Intracellular calcium ion imaging system (AquaCosmos) | (24) Imaging flowcytometer (ImageStream <sup>×</sup> )      |
|                                                      |                                                            | (25) Cell sorter (S3)                                       |

# 3<sup>rd</sup> Floor of Basic Medicine Building

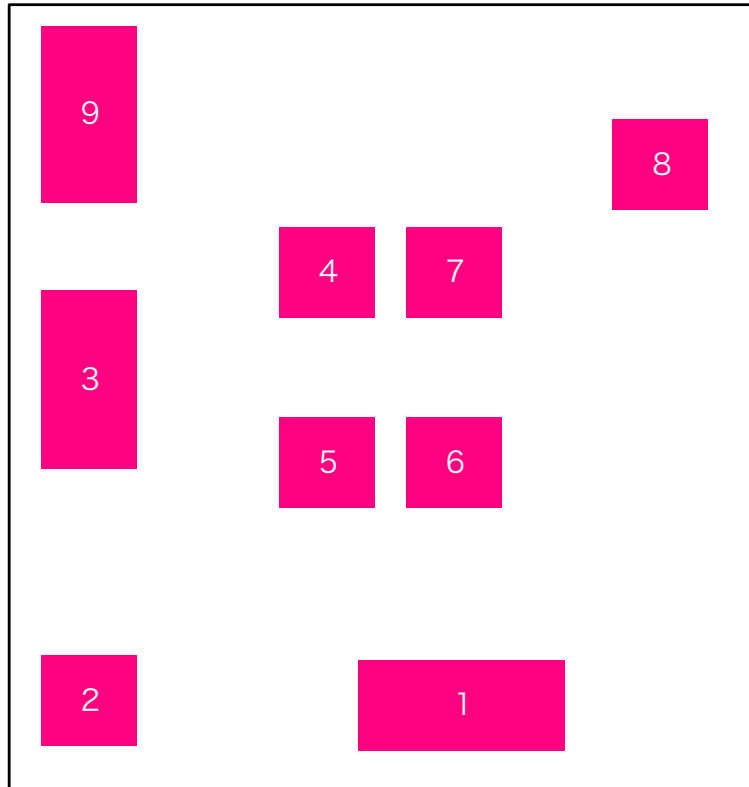

- (1) Inkjet printer (PX-H9000)
- (2) CCD imager (LAS-4010)
- (3) Laser microdissection system (Axio Observer/PALM)
- (4) Whole slide imaging system (toco)
- (5) Fluorescence microscope (BZ-X700)
- (6) Fluorescence microscope (BZ-9000)
- (7) Confocal laser scanning microscope (FV10i-DOC)
- (8) Fluorescence microscope (BZ-8100)
- (9) Confocal laser scanning microscope (FV1000-D)

# 1<sup>st</sup> Floor of Basic Medicine Building

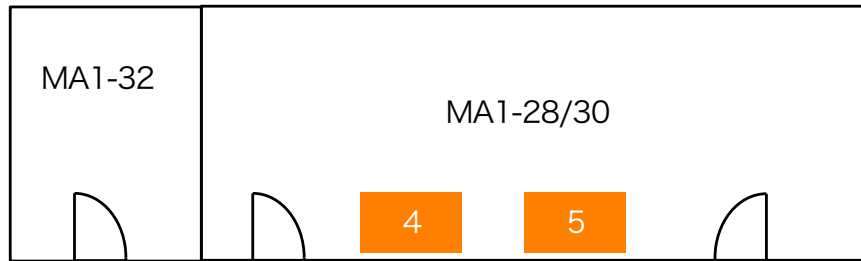

- (1) Liquid chromatograph-mass spectrometer (LCMS-8050)
- (2) Gas chromatograph-mass spectrometer (7890B/5977 MSD)
- (3) Liquid chromatograph-mass spectrometer (TripleTOF 6600)
- (4) Next generation sequencer (NextSeq)
- (5) Next generation sequencer (MiSeq)
- (6) Isoelectric focusing system (Ettan IPGPhor 3)
- (7) Pulsed-field electrophoresis system (PippinPulse)
- (8) Analysis PC for metabolomics

